

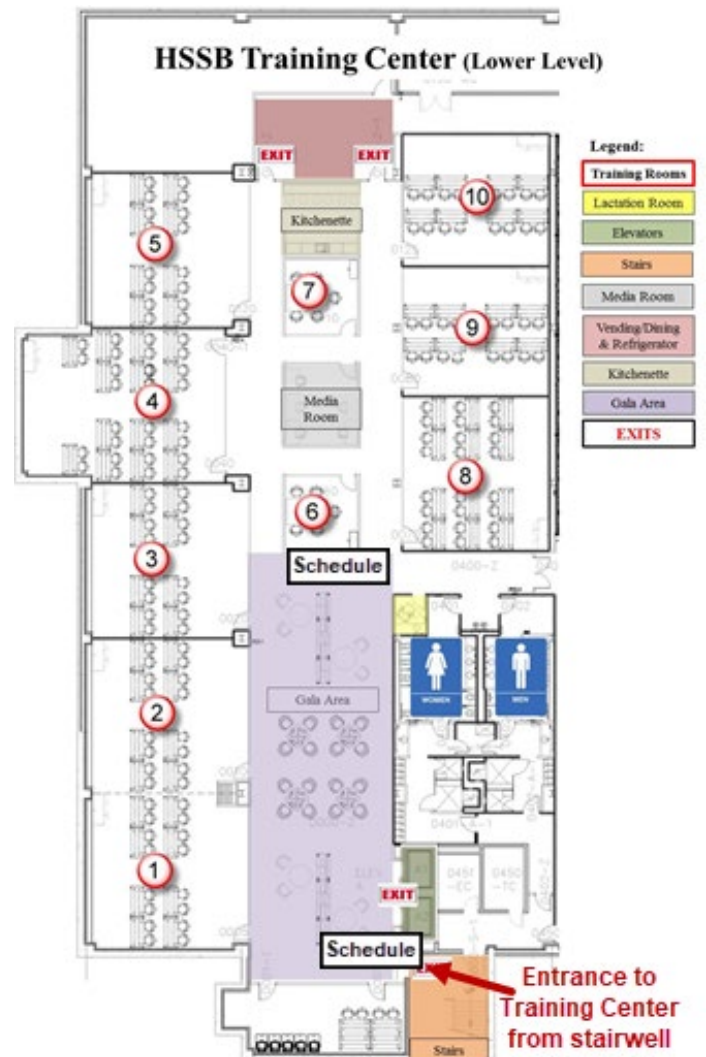

The University of Iowa Health Care Hospital Support Services Building (HSSB) Training Center is located at **3281 Ridgeway Drive in Coralville**, just east of Highway 965. See page 2 for CAMBUS information.

Parking, Building Entry, and Classroom Information

- Trainees with a **permit for any UI parking lot** may park on either the North or South side of the building. Trainees without a UI parking permit must park in the designated **Visitor** parking area and register their vehicle upon arrival (license/make/model). **Accessible parking** is available along the West side of the building, across from the entrance.
- Trainees should enter the building through the **Main Entrance** (★) on the Southwest corner of the building. The entrance to the building is at street level. The Training Center is located on the lower level. After entering the building, take the stairs or the elevator to the lower level.
- Refer to the schedules posted in the Training Center on the day of training for room information. The name of your specific Epic class is in the confirmation email you received.
- **The HSSB building and the Training Center do not open until 7:30 am.** Please plan your travel to this location accordingly.



For a Successful Training Experience:

- Arrive at the facility 10 to 15 minutes before the Epic training session is scheduled to begin. There is no need to check in at the front desk unless you need to register a vehicle in visitor parking.
- Late-comers **may not** be allowed to join a session and **might need to reschedule** with their supervisor. All trainings are time-sensitive; training room doors will be closed fifteen minutes after the start time.
- Staff are required to stay for the entire training session in order to obtain Epic security access.
- Bring your staff ID badge as these may be used to record attendance.
- Turn off cell phones and pagers during training.
- DO wear layers in case of varying in-class temperatures and DO NOT wear cologne or perfume.
- Come prepared to learn new applications and technology.

CAMBUS Transportation

CAMBUS is the University's public transit system that provides fixed-route service throughout the campus at no charge to the riders. When taking the CAMBUS from UIHC, board the outgoing bus at the VA Loop. The trip is approximately 23 minutes each way. When departing HSSB, board the CAMBUS on the West side of the building adjacent to the Main Entrance. Visit this website for current departure and arrival times:

<https://transportation.uiowa.edu/research-park-route-schedule>

Amenities & Food Options

If your class is going to span lunch, please be prepared. Most classes do not break for more than 30 minutes for lunch. You may eat your lunch in the Gala or Vending/Dining spaces indicated on the Training Center map.

- If you bring your own lunch, there are refrigerators located in the Kitchenette and the Vending/Dining areas and a shared microwave.
- There are Keurig machines available in the Training Center. Feel free to bring Keurig cups if you would like a hot beverage. Please bring your own covered hot beverage container.
- Covered drinks and snacks are typically allowed in the training rooms.
- A filtered water dispenser is located outside the restrooms for your use.
- UIHC Food & Nutrition manages the Ridgeway Trail Café next to the Main Entrance. The Café is open until 2:30 pm daily and accepts credit cards and UIHC badges that have charging enabled for payment.
Please Note: The Café is not accepting cash at this time.

Lactation Room

There is a lactation room in the Training Center. Please notify your instructor on the day of training to schedule this room.

Badging Station

A badging station for clocking in and out is available next to the elevators in the Gala Area.